

# Building AI Applications

Leveraging InstructLab and BeeAI

Martin Hickey

@mhickeybot.bsky.social

Paul Schweigert

psschwei.com

# How to build better AI applications

- Find-tune SLM/LLM models with domain specific data
- Use SLMs/LLMs to execute complex, multi-step workflows

# InstructLab

Fine-tune SLMs/LLMs with additional data sources

# Why InstructLab?



- Don't require AI tuning knowledge
- Knowledge added to base model to tune new model
- Base model can be updated independently
- Community based – domain data can be kept confidential

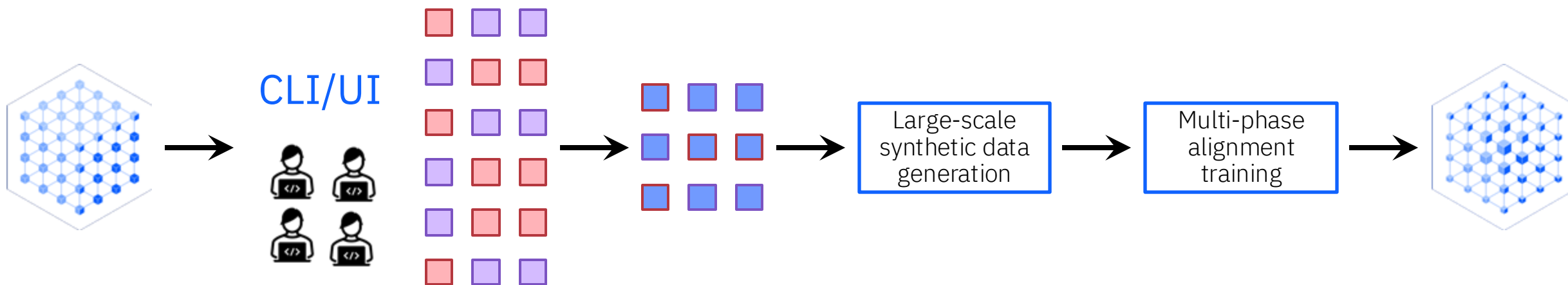

# BeeAI

Use SLMs/LLMs to execute complex, multi-step workflows



# Why BeeAI?

- Open source platform for building chat assistants and custom AI-powered apps
- Built for open source models (including Llama, Granite, and DeepSeek R1)
- Bee UI lets you create agents without knowing how to code
- Provides observability tools for monitoring and troubleshooting
- Broad integration with third-party tools like Model Context Protocol (MCP)

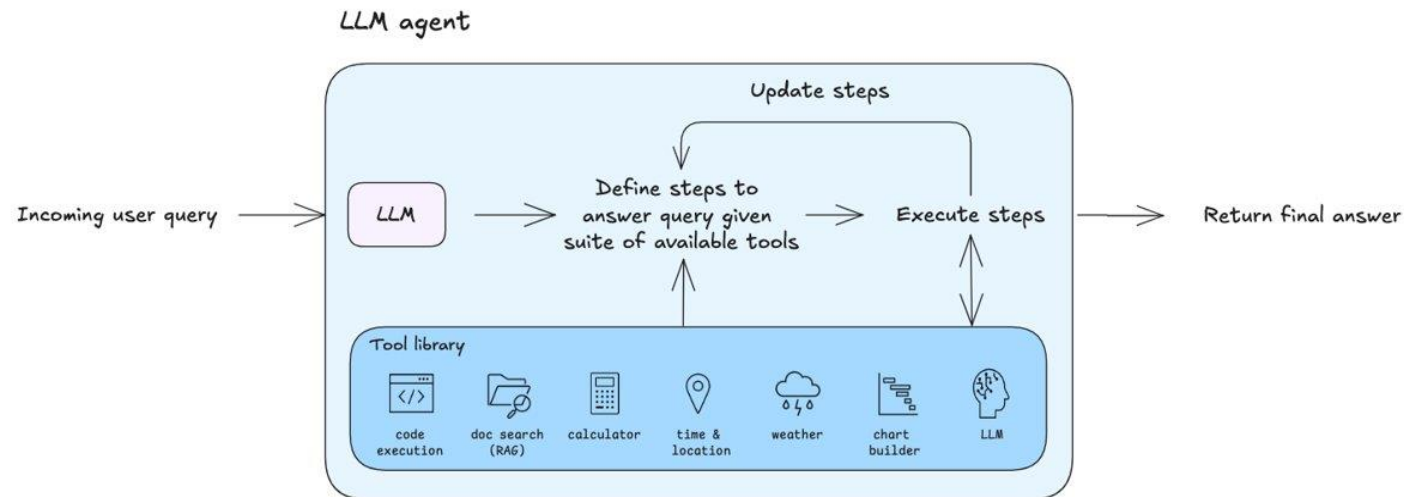

# Thank You!



<https://instructlab.ai/>



<https://i-am-bee.github.io/bee-agent-framework/>